

RM310 GEARED MOTOR INSTALLATION DETAILS

Maximum performance details listed below are at 6 bar / 90 psi. The performance under different conditions can be obtained by using the curves on page 22. A typical minimum gearbox efficiency of 90% can be expected. For higher pressures contact SPX Hydraulic Technologies.

The maximum overhung force is assumed acting midway along the output shaft; for other positions or higher loads on intermittent applications; contact SPX Hydraulic Technologies.

PERFORMANCE SUMMARY

GEARBOX RATIO	MAXIMUM POWER CONDITIONS					APPROX. MIN. START TORQUE		MAX. CONT. rmp	MAX. OVERHUNG FORCE		WEIGHT			
	kW	hp	rpm	Nm	lbf. ft	Nm	lbf. ft		N	lbf.	GEARBOX	ADAPTER	GEARBOX KIT	MOTOR & GEARBOX
5.15	6.37	8.5	350	165	122	170	125	461	2350	528	38	14	52	100
25.01	6.37	8.5	72	800	591	824	608	95	14060	3161	92	14	106	154
51.97	6.37	8.5	35	1663	1227	1713	1264	46	18830	4233	130	14	144	192
78.06	6.37	8.5	23	2498	1843	2573	1899	30	26070	5861	194	14	208	256
103.80	6.37	8.5	17	3322	2451	3421	2525	23	26070	5861	194	14	208	256
123.37	6.37	8.5	15	3948	2914	4066	3001	19	27600	6205	312	14	326	374
156.38	6.37	8.5	12	5004	3693	5154	3804	15	35280	7932	312	14	326	374
178.38	6.37	8.5	10	5708	4213	5879	4339	13	86311	19404	475	14	489	537
198.71	6.37	8.5	9	6359	4693	6549	4834	12	86311	19404	475	14	489	537
253.08	6.37	8.5	7	8099	5977	8342	6156	9	86311	19404	475	14	489	537

For additional types and ratios contact SPX Hydraulic Technologies.

BASE MOUNTED GEAR BOX DIMENSIONS

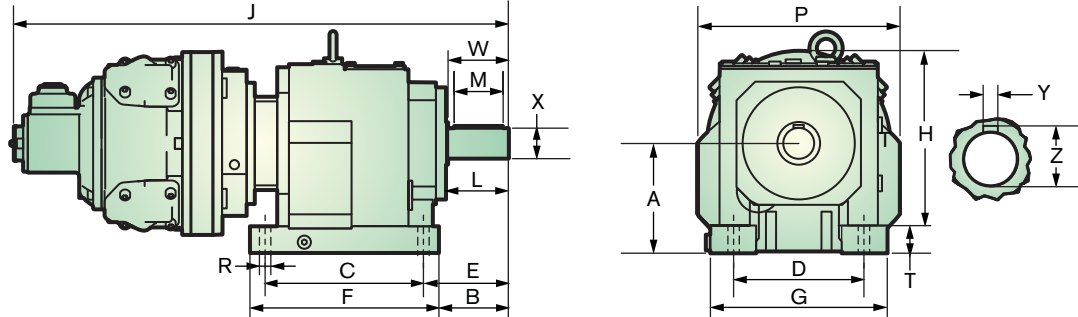

RANGE RATIO	A	B	C	D	E	F	G	H	J	L	M	P	R	T	W	X	Y	Z	MASS
4.28 - 6.9:1	115 + 35	92.5	165	135	110	200	195	265 + 35	722	83	70	300	13.5	25	70	40.01	12	43	96 kg
	4.5" + 1.4"	3.0"	6.5"	5.3"	4.3"	7.9"	7.7"	10.4"+1.4"	28.4"	3.3"	2.8"	11.8"	0.5"	1.0"	2.8"	1.585"	0.5"	1.7"	212 lb
8.11 - 16.45	140 + 10	95	205	170	115	245	235	290 + 10	748	84	70	290	17.5	30	80	40.01	12	43	113 kg
	5.5" + 0.4"	3.7"	8.1"	6.7"	4.5"	9.6"	9.3"	11.4" + 0.4"	29.4"	3.3"	2.8"	11.4"	0.7"	1.2"	3.1"	1.585"	0.5"	1.7"	250 lb
20.81 - 31.32	180	115	260	215	140	310	290	364	806	104	80	332	17.5	45	100	50.01	14	53.5	150 kg
	7.1"	4.5"	10.2"	8.5"	5.5"	12.2"	11.4"	14.3"	31.7"	4.1"	3.1"	13.1"	0.7"	1.8"	3.9"	1.985"	0.6"	2.1"	330 lb
35.14 - 60.9:1	225	132	310	250	159.5	365	340	445	891	125	100	410	22	50	120	60.02	18	64	184 kg
	8.9"	5.2"	12.2"	9.8"	6.3"	14.4"	13.4"	17.5"	35.0"	4.9"	3.9"	16.1"	0.9"	2.0"	4.7"	2.38"	0.7"	2.5"	406 lb
78.06 - 88.46:1	250	150	370	290	185	440	400	507	965	145	110	462	26	55	140	70.02	20	74.5	252 kg
	9.8"	5.9"	14.6"	11.4"	7.3"	17.3"	15.7"	20.0"	38.0"	5.7"	4.3"	18.2"	1.0"	2.2"	5.5"	2.78"	0.8"	2.9"	556 lb

FLANGE MOUNTED GEAR BOX DIMENSIONS

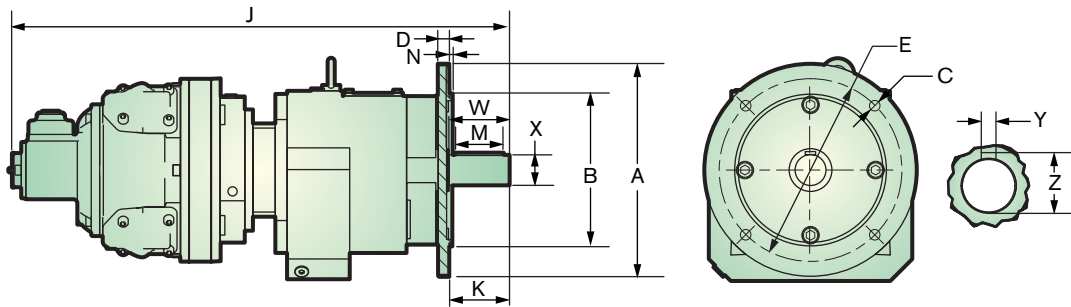

RANGE RATIO	A	B	C	D	E	J	K	M	N	W	X	Y	Z	MASS
4.28 - 6.9:1	300	230.00	13.5	15	265	721	80	70	4	80	40.01	12.0	43	96 kg
	11.8"	9.1"	0.5"	0.6"	10.4"	28.4"	3.1"	2.8"	0.2"	3.1"	1.6"	0.5"	1.7"	212 lb
8.11 - 16.45:1	300	230.00	13.5	16	265	749	80	70	4	80	40.01	12.0	43	113 kg
	11.8"	9.1"	0.5"	0.6"	10.4"	29.5"	3.1"	2.8"	0.2"	3.1"	1.6"	0.5"	1.7"	250 lb
20.81 - 31.32:1	350	250.01	17.5	18	300	806	100	80	5	100	50.01	14	53.5	150 kg
	13.8"	9.8"	0.7"	0.7"	11.8"	31.7"	3.9"	3.1"	0.2"	3.9"	2.0"	0.6"	2.1"	330 lb
35.14 - 60.9:1	450	350.00	17.5	20	400	891	120	100	5	120	60.02	18	64	188 kg
	17.7"	13.8"	0.7"	0.8"	15.7"	35.1"	4.7"	3.9"	0.2"	4.7"	2.4"	0.7"	2.5"	414 lb
78.06 - 88.46:1	550	450.00	17.5	22	500	969	140	110	5	140	70.02	20	74.5	252 kg
	21.7"	17.7"	0.7"	0.9"	19.7"	38.1"	5.5"	4.3"	0.2"	5.5"	2.8"	0.8"	2.9"	556 lb

Detailed drawings and CAD models available on request. Ratios above the basic range shown are available on request. Alternative gearbox types and arrangements i.e. right angle output, hollow shaft etc. also available.

Modified dimensions for shafts and flanges available on request.